



SQUARE INSERT END MILLS

HS Series



- For square shoulder milling, facing, counterboring, and pocketing
- Good performance in low power machines
- Four indexes per insert
- Coolant through
- Cutter bodies made in the USA

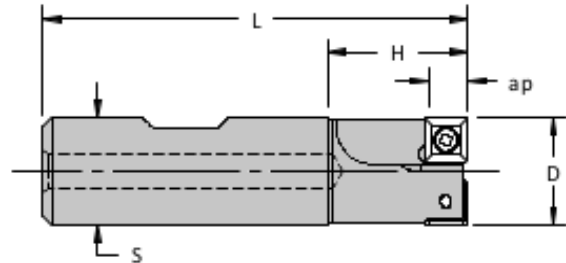

Cut Dia. D	Part Number	Dimensions (inches)			Max. DOC ap	No. of Inserts	Insert	Standard Components
		S	L	H				Screw
0.375	HS-010	0.375	2.25	0.625	0.23	1	SDEB-21.51	3-48 X 1/8
0.500	HS-020	0.500	2.62	0.625	0.22	1	SPEH-222	3-48 X 3/16
0.625	HS-030	0.625	3.12	0.875	0.22	2		
0.750	HS-040	0.750	3.03	1.000	0.28	2	SPEH-2.522	3-48 X 1/4
1.000	HS-050	0.750	3.03	1.000	0.28	3		
1.250	HS-060	0.750	3.28	1.250	0.34	3	SPEH-332	5-40 X 3/8
1.500	HS-070	0.750	3.28	1.250	0.34	3		
2.000	HS-080	0.750	3.28	1.250	0.34	4		

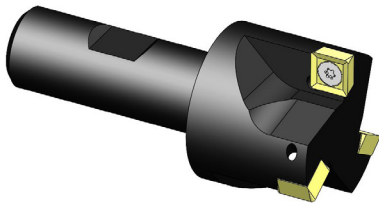

IC	Part Number	Thickness	Clearance Angle	Corner Radius	Coatings				Image
					None	TiCN	TiN	TiAlN	
0.250	SDEB-21.51	0.094	15°	0.015	•	○	•	○	
0.250	SPEH-222	0.125	11°	0.031	•	○	•	○	
0.313	SPEH-2.522	0.125	11°	0.031	•	○	•	○	
0.375	SPEH-332	0.187	11°	0.031	•	○	•	○	

SHOULDER MILLS