



FULL RADIUS

RT Series Shank Type



- For milling slots with a full radius bottom
- Not recommended for facing, back facing, or contouring
- One-piece body construction
- Positive hi-shear geometry
- Special sizes can be quoted
- Cutter bodies and inserts made in the USA

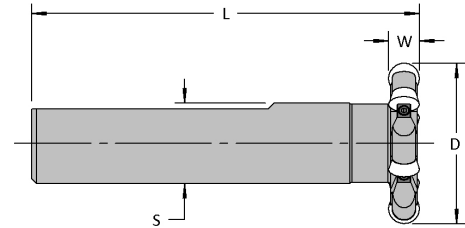

Max DOC ar	Part Number	Dimensions (inches)				No. of Inserts	Insert	Standard Components	
		W	D	S	L			Wedge	Screw
0.20	RT-010	0.125	1.00	0.75	4.50	4	RPC1(1.36)	X	1H15S27
0.50	RT-020	0.125	2.00	1.00	4.75	6			
0.87	RT-030	0.125	3.00	1.25	5.75	8			
0.20	RT-040	0.156	1.00	0.75	4.50	4	RDC1.25(1.5)	3W000	3DS312
0.50	RT-050	0.156	2.00	1.00	4.75	6			
0.87	RT-060	0.156	3.00	1.25	5.75	8			
0.37	RT-070	0.188	1.50	0.75	4.50	4	RDC1.5(1.5)	3W000	3DS312
0.50	RT-080	0.188	2.00	1.00	4.75	6			
0.87	RT-090	0.188	3.00	1.25	5.75	8			
0.37	RT-100	0.250	1.50	0.75	4.50	4	RDC21	6W006	6DS343
0.50	RT-110	0.250	2.00	1.00	4.75	6			
0.87	RT-120	0.250	3.00	1.25	5.75	8			
0.37	RT-130	0.313	1.50	0.75	4.50	4	RDC2.5(2.5)	6W006	6DS343
0.50	RT-140	0.313	2.00	1.00	4.75	6			
0.87	RT-150	0.313	3.00	1.25	5.75	8			
0.37	RT-160	0.375	1.50	0.75	4.50	4	RDC3(2.5)	6W006	6DS343
0.50	RT-170	0.375	2.00	1.00	4.75	6			
0.87	RT-180	0.375	3.00	1.25	5.75	8			

Size	Part Number	IC	Thickness	Clearance Angle	Coatings				Image
					None	TiCN	TiN	TiAlN	
1/8"	RPC1(1.36)	0.1250	0.085	11°	•	○	•	○	
5/32"	RDC1.25(1.5)	0.1562	0.094	15°	•	○	•	○	
3/16"	RDC1.5(1.5)	0.1875	0.094	15°	•	○	•	○	
1/4"	RDC21	0.2500	0.125	15°	•	•	•	•	
5/16"	RDC2.5(2.5)	0.3125	0.156	15°	•	•	•	•	
3/8"	RDC3(2.5)	0.3750	0.156	15°	•	•	•	•	

SLOTING CUTTERS